

FLAVORSEAL® Pumps and Pump Stations

Product Name: Mid-Size Pump

General Description

Mid-Size pump filler is ideal for pumping a wide variety of liquid or semi-liquid products with or without particulates into bags, casings or other containers.

Features

The mid size pump fill station is available in two sizes: 16-64oz. per stroke with 2 inch connections or a 32-160oz per stroke piston with 3 inch connections.

- Volumes are adjusted using an external hand crank.
- USDA approved stainless steel construction
- Tilt mechanism allows for easy switching between kettles
- Locking swivel casters
- Pouch platform for support during filling

Closing assembly options

All options feature height and swivel adjustments to accommodate any bag size.

- Angle seal dual element heat sealer
- a CMS exclusive!
- 1/4" dual element straight heat sealer
- Air actuated or manual clippers

Additional Options

- Spare Parts Kit
- Printer
- Waste bins
- The 16-64oz pump can be ordered in three different volume options:
 - 4-16oz per stroke piston
 - 8-32oz per stroke piston
 - 16-64oz per stroke piston



Optional straight-line heat sealer attachment



Optional clipper attachment



0201/10

FLAVORSEAL® Pumps and Pump Stations

Product Name: Mid-Size Pump

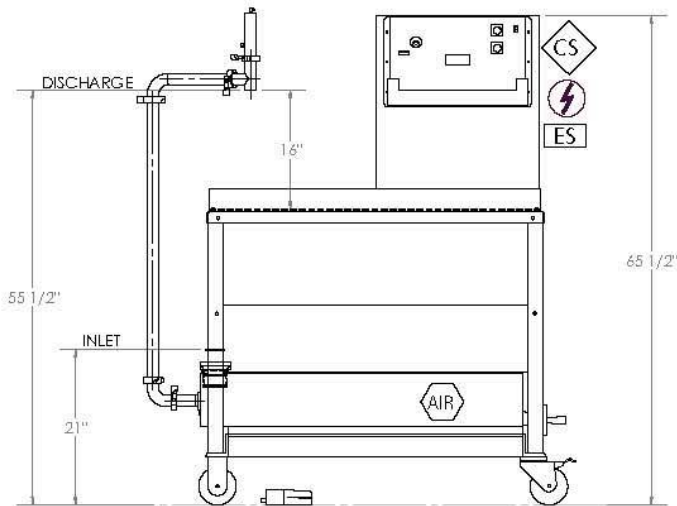
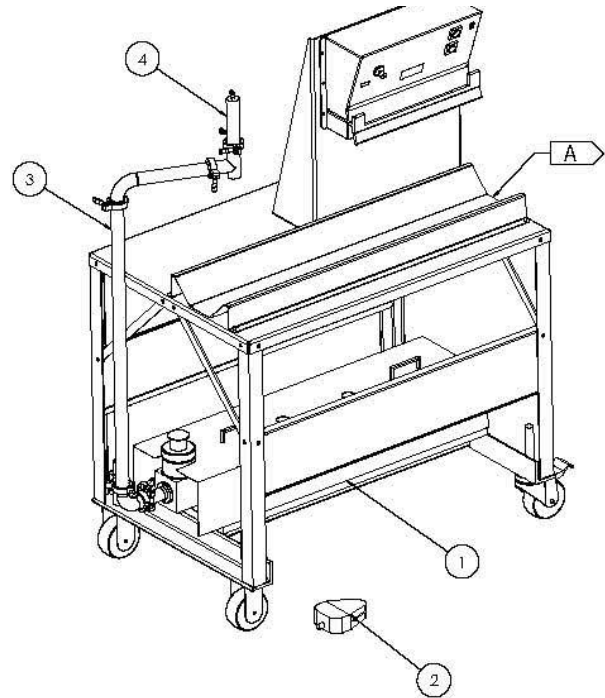
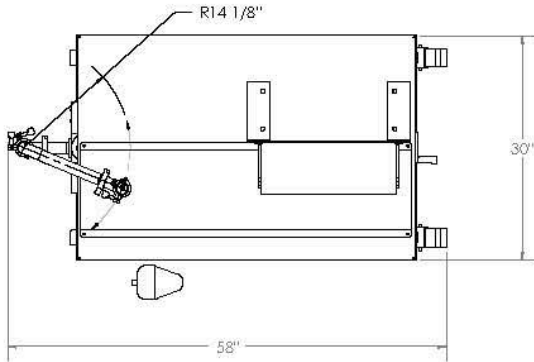

ITEM NO.	EQUIPMENT PROVIDED BY HINDS-BOCK	QTY
1	SP-64 PUMP FILLER	1
2	FOOT SWITCH, AIR	1
3	DISCHARGE PIPE, 1-1/2"	1
4	CUT-OFF SPOUT, 1-1/2"	1

NOTES:

ALL DIMENSIONS ARE FOR REFERENCE ONLY.
 SCFM: TO BE DETERMINED @ 90 PSI
 MAXIMUM ALLOWABLE PRESSURE DROP: 10 PSI
 POUCH SUPPORT PLATFORM

A

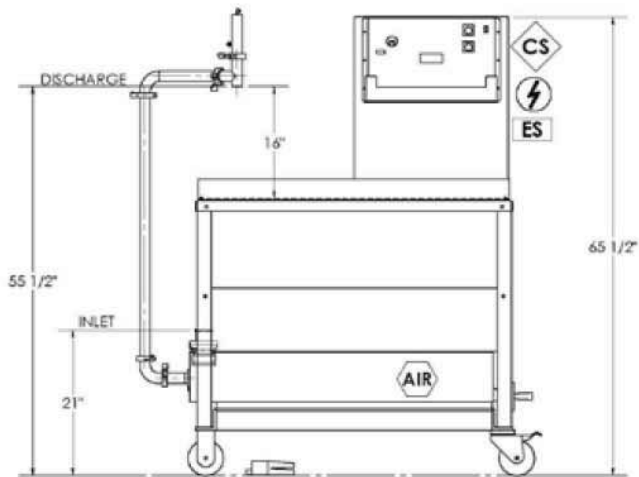

LEGEND

ES	E-STOP	AIR	AIR DROP: 1/2" NPT
⚡	POWER DROP	CS	CONTROL STATION